

# TRUE HOME CABINS LIMITED

FABRICATION + CONSTRUCTION  
RELOCATABLE CABINS & TINY HOMES

*We build cabins*

Affordable & Attractive

Built on demand to your specifications

**Mini**  
CABINS Ideal as an Extra Bedroom,  
Studio or Home Office

**Midi**  
CABINS Add functionality with a  
Kitchenette & Bathroom

**MAXi**  
CABINS Fantastic Tiny Home, First Home  
or Rental Investment

*"Exceptional from initial talk to delivery, nothing was a problem even when we made changes 3 weeks out from delivery. I highly recommend and have offered for them to use mine as a show home as I am so appreciative of their hard work and attention to detail."* SANDY OSBOURNE



Apply Now

Phone 027 TRU HOME - 027 878 4663

[www.truehomecabins.co.nz](http://www.truehomecabins.co.nz)

[facebook.com/TrueHomeCabins](https://facebook.com/TrueHomeCabins)

## No Hidden Costs

Built from quality materials and supplied with compliance certifications. All costs are upfront.

Trust in 50 years worth of combined experience to expertly construct your cabin.

## Customisable

Our friendly team will help you to plan your ideas and design your own purpose built cabin to meet your needs.

From an extra window or additional power outlets to a custom built kitchen you will feel right at home in your True Home Cabin.

## Our Process

### 1. Initial consultation

An initial consultation allows us to get to know you better and tailor our products and services to your needs.

### 2. Quote

We'll send you a quote to review. Once you have approved our quote we require a 50% deposit before production can start.

### 3. Production

Materials are ordered and your Tiny Home is put into the production pipeline.

### 4. Your order is ready!

Once production is complete and your final payment is made, we arrange for your new Tiny Home to be delivered.



# Mini CABINS

Ideal for an Extra Bedroom,  
Studio or a Home Office

## CORE SPECIFICATIONS

### INTERIOR

- Expol Black R1.8 Underfloor Insulation
- Earthwool Insulation in the Walls and Ceiling
- H3.2 Tongue and Groove Ply Flooring
- Carpet with Underlay and/ or Vinyl Floor Coverings
- RCD Power Protection
- 16amp or 32amp Power Connection
- Interior LED Downlights
- Multiple Double Power Points

### EXTERIOR

- Galvanised Steel Chassis
- H1.2 Treated Timber Framing
- Gable or Mono Pitched Roof
- Clad in Textured or Grooved Shadowclad H3.1
- Marley Guttering
- Exterior LED Light

### CHOOSE YOUR COLOURS FOR

- The **INTERIOR**
- The **EXTERIOR**
- **ALUMINIUM JOINERY**
- **ROOFING & FLASHINGS**



4.2m x 2.4m

10sqm  
from  
\$19,000

Single Room Unit

4.8m x 2.4m

12sqm  
from  
\$21,000

Single Room Unit



4.2m x 2.4m



4.8m x 2.4m

- OPTIONS**
- Kitchenette with electric hot water (4.8m x 2.4m only)



Apply Now

Prices include GST. OPTIONS incur an additional cost. DELIVERY cost is extra. Floor-plans are an artistic impression and not to scale. Furniture and accessories are not included. Specifications and prices are subject to change without notice.

Feels like home

Phone 027 TRU HOME - 027 878 4663

[www.truehomecabins.co.nz](http://www.truehomecabins.co.nz)

[facebook.com/TrueHomeCabins](https://facebook.com/TrueHomeCabins)

# MiDi CABiNS

## Add functionality with a Kitchenette & Bathroom



### CORE SPECIFICATIONS

#### INTERIOR

- Expol Black R1.8 Underfloor Insulation
- Earthwool Insulation in the Walls and Ceiling
- H3.2 Tongue and Groove Ply Flooring
- Carpet with Underlay and/ or Vinyl Floor Coverings
- RCD Power Protection
- 16amp or 32amp Power Connection
- Interior LED Downlights
- Multiple Double Power Points
- Cavity Slider Internal Doors

#### EXTERIOR

- Galvanised Steel Chassis
- H1.2 Treated Timber Framing
- Gable or Mono Pitched Roof
- Clad in Textured or Grooved Shadowclad H3.1
- Marley Guttering
- Exterior LED Light

#### CHOOSE YOUR COLOURS FOR

- The **INTERIOR**
- The **EXTERIOR**
- **ALUMINIUM JOINERY**
- **ROOFING & FLASHINGS**

6m x 2.4m

15sqm  
from  
\$48,000

**Kitchenette + Bathroom**

- Kitchenette**
- Soft Close Cabinetry & Drawers
  - Stainless Steel Sink with Mixer
  - Gas Oven & Hob - Thetford • Rangehood

- Bathroom**
- Shower - Full 900mm x 900mm with Shower Dome
  - Vanity with Cabinet/Mirror • Extractor Fan
  - Toilet - Flushing or Cassette

- Hot Water**
- 16L Gas Califont

- OPTIONS**  
(Additional Cost)
- Swap Oven & Hob Type
  - Swap Standard Toilet to Composting or Incinerating
  - Add Heat Pump

6m x 2.4m from \$48,000



6m x 2.4m

9m x 2.4m

21.5sqm  
from  
\$72,000

**1 Bedroom + Kitchenette + Bathroom**

- Kitchenette**
- Soft Close Cabinetry & Drawers
  - Stainless Steel Sink with Mixer
  - Gas Oven & Hob - Thetford • Rangehood

- Bathroom**
- Shower - Full 900mm x 900mm with Shower Dome
  - Vanity with Cabinet/Mirror • Extractor Fan
  - Toilet - Flushing or Cassette

- Hot Water**
- 16L Gas Califont

- OPTIONS**  
(Additional Cost)
- Swap Oven & Hob Type
  - Swap Standard Toilet to Composting or Incinerating
  - Add Heat Pump

9m x 2.4m from \$72,000



9m x 2.4m

Prices include GST. Delivery cost is extra. Floor-plans are an artistic impression and not to scale. Furniture and accessories are not included. Specifications and prices are subject to change without notice.



Apply Now

Feels like home

Phone 027 TRU HOME - 027 878 4663

[www.truehomecabins.co.nz](http://www.truehomecabins.co.nz)

[facebook.com/TrueHomeCabins](https://facebook.com/TrueHomeCabins)

# MiDi CABiNS

## Add functionality with a Kitchenette & Bathroom



8.4m x 3m

25sqm  
from  
\$80,500

1 Bedroom + Kitchenette  
+ Bathroom

Choose 1 of 3 Floorplans

- Kitchenette**
- Soft Close Cabinetry & Drawers
  - Stainless Steel Sink with Mixer
  - Gas Oven & Hob • Rangehood

- Bathroom**
- Shower - Full 900mm x 900mm with Shower Dome
  - Vanity with Cabinet/Mirror • Extractor Fan
  - Toilet - Flushing or Cassette

- Hot Water**
- 16L Gas Califont

- OPTIONS**  
(Additional Cost)
- Swap Oven & Hob Type
  - Swap Standard Toilet to Composting or Incinerating
  - Add Heat Pump

### CORE SPECIFICATIONS

#### INTERIOR

- Expol Black R1.8 Underfloor Insulation
- Earthwool Insulation in the Walls and Ceiling
- H3.2 Tongue and Groove Ply Flooring
- Carpet with Underlay and/ or Vinyl Floor Coverings
- RCD Power Protection
- 16amp or 32amp Power Connection
- Interior LED Downlights
- Multiple Double Power Points
- Cavity Slider Internal Doors

#### EXTERIOR

- Galvanised Steel Chassis
- H1.2 Treated Timber Framing
- Gable or Mono Pitched Roof
- Clad in Textured or Grooved Shadowclad H3.1
- Marley Guttering
- Exterior LED Light

#### CHOOSE YOUR COLOURS FOR

- The **INTERIOR**
- The **EXTERIOR**
- **ALUMINIUM JOINERY**
- **ROOFING & FLASHINGS**

8.4m x 3m from \$80,500



8.4m x 3m Option A



8.4m x 3m Option B



8.4m x 3m Option C

Prices include GST. Delivery cost is extra. Floor-plans are an artistic impression and not to scale. Furniture and accessories are not included. Specifications and prices are subject to change without notice.



Apply Now

Feels like home

Phone 027 TRU HOME - 027 878 4663

[www.truehomecabins.co.nz](http://www.truehomecabins.co.nz)

[facebook.com/TrueHomeCabins](https://facebook.com/TrueHomeCabins)

# MAXI CABINS

## Fantastic Tiny Home, First Home or Rental Investment



<b>9m x 3m</b>	27sqm from <b>\$92,000</b>	<b>1 Bedroom + Kitchenette + Bathroom</b>
----------------	----------------------------	---

- Kitchenette**
- Soft Close Cabinetry & Drawers
  - Stainless Steel Sink with Mixer
  - Gas Oven & Hob • Rangehood
- Bathroom**
- Shower - Full 900mm x 900mm with Shower Dome
  - Vanity with Cabinet/Mirror • Extractor Fan
  - Toilet - Flushing or Cassette
- Hot Water**
- 16L Gas Califont
- OPTIONS** (Additional Cost)
- Swap Oven & Hob Type
  - Swap Standard Toilet to Composting or Incinerating
  - Add Heat Pump

<b>10.2m x 3m</b>	30sqm from <b>\$96,600</b>	<b>1 Bedroom + Kitchenette + Bathroom</b>
-------------------	----------------------------	---

<b>10.2m x 3m</b>	30sqm from <b>\$98,600</b>	<b>2 Bedroom + Kitchenette + Bathroom</b>
-------------------	----------------------------	---

- Kitchenette**
- Soft Close Cabinetry & Drawers
  - Stainless Steel Sink with Mixer
  - Gas Oven & Hob • Rangehood
- Bathroom**
- Shower - Full 900mm x 900mm with Shower Dome
  - Vanity with Cabinet/Mirror • Extractor Fan
  - Toilet - Flushing or Cassette
- Hot Water**
- 16L Gas Califont
- OPTIONS** (Additional Cost)
- Swap Oven & Hob Type
  - Swap Standard Toilet to Composting or Incinerating
  - Add Heat Pump

### CORE SPECIFICATIONS

- INTERIOR**
- Expol Black R1.8 Underfloor Insulation
  - Earthwool Insulation in the Walls and Ceiling
  - H3.2 Tongue and Groove Ply Flooring
  - Carpet with Underlay and/or Vinyl Floor Coverings
  - RCD Power Protection
  - 16amp or 32amp Power Connection
  - Interior LED Downlights
  - Multiple Double Power Points
  - Cavity Slider Internal Doors
- EXTERIOR**
- Galvanised Steel Chassis
  - H1.2 Treated Timber Framing
  - Gable or Mono Pitched Roof
  - Clad in Textured or Grooved Shadowclad H3.1
  - Marley Guttering
  - Exterior LED Light
- CHOOSE YOUR COLOURS FOR**
- The **INTERIOR**
  - The **EXTERIOR**
  - **ALUMINIUM JOINERY**
  - **ROOFING & FLASHINGS**

### 9m x 3m from \$92,000



9m x 3m

### 1 Bedroom 10.2m x 3m from \$96,600



1 Bedroom 10.2m x 3m

### 2 Bedroom 10.2m x 3m from \$98,600



2 Bedroom 10.2m x 3m

Prices include gst. Delivery cost is extra. Floor-plans are an artistic impression and not to scale. Furniture and decks are not included. Specifications and prices are subject to change without notice.

18/09/23



Phone 027 TRU HOME - 027 878 4663

[www.truehomecabins.co.nz](http://www.truehomecabins.co.nz)

[facebook.com/TrueHomeCabins](https://facebook.com/TrueHomeCabins)

# MAXI CABINS

## Fantastic Tiny Home, First Home or Rental Investment



12m x 3.6m

<b>12m x 3.6m</b>	45.6sqm from \$145,000	<b>1 Bedroom + Kitchenette + Bathroom</b>
<b>12m x 3.6m</b>	45.6sqm from \$150,000	<b>2 Bedroom + Kitchenette + Bathroom</b>

- Kitchenette**
- Soft Close Cabinetry & Drawers
  - Stainless Steel Sink with Mixer
  - Gas Oven & Hob • Rangehood

- Bathroom**
- Shower - Full 900mm x 900mm with Shower Dome
  - Vanity with Cabinet/Mirror • Extractor Fan
  - Toilet - Flushing or Cassette

- Hot Water**
- 16L Gas Califont

- OPTIONS**  
(Additional Cost)
- Swap Oven & Hob Type
  - Swap Standard Toilet to Composting or Incinerating
  - Add Heat Pump

### CORE SPECIFICATIONS

#### INTERIOR

- Expol Black R1.8 Underfloor Insulation
- Earthwool Insulation in the Walls and Ceiling
- H3.2 Tongue and Groove Ply Flooring
- Carpet with Underlay and/ or Vinyl Floor Coverings
- RCD Power Protection
- 16amp or 32amp Power Connection
- Interior LED Downlights
- Multiple Double Power Points
- Cavity Slider Internal Doors

#### EXTERIOR

- Galvanised Steel Chassis
- H1.2 Treated Timber Framing
- Gable or Mono Pitched Roof
- Clad in Textured or Grooved Shadowclad H3.1
- Marley Guttering
- Exterior LED Light

#### CHOOSE YOUR COLOURS FOR

- The **INTERIOR**
- The **EXTERIOR**
- **ALUMINIUM JOINERY**
- **ROOFING & FLASHINGS**

### 1 Bedroom 12m x 3.6m from \$145,000



1 Bedroom 12m x 3.6m

### 2 Bedroom 12m x 3.6m from \$150,000

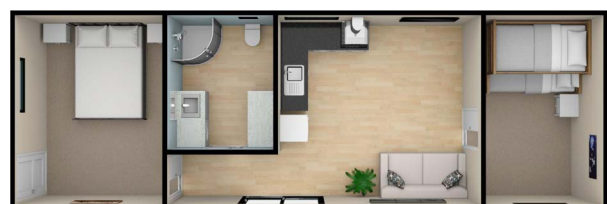

2 Bedroom 12m x 3.6m



Apply Now

Prices include gst. Delivery cost is extra. Floor-plans are an artistic impression and not to scale. Furniture and decks are not included. Specifications and prices are subject to change without notice.

18/09/23



Phone 027 TRU HOME - 027 878 4663

[www.truehomecabins.co.nz](http://www.truehomecabins.co.nz)

[facebook.com/TrueHomeCabins](https://facebook.com/TrueHomeCabins)

Feels like home

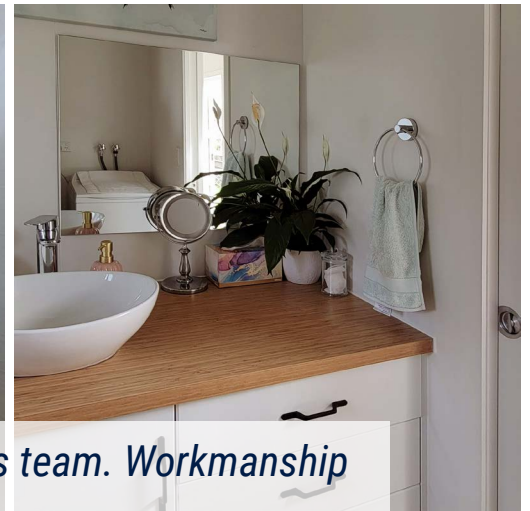

*"Love my home and highly recommend this team. Workmanship is excellent and nothing was a problem."*

MAUREEN NESBITT

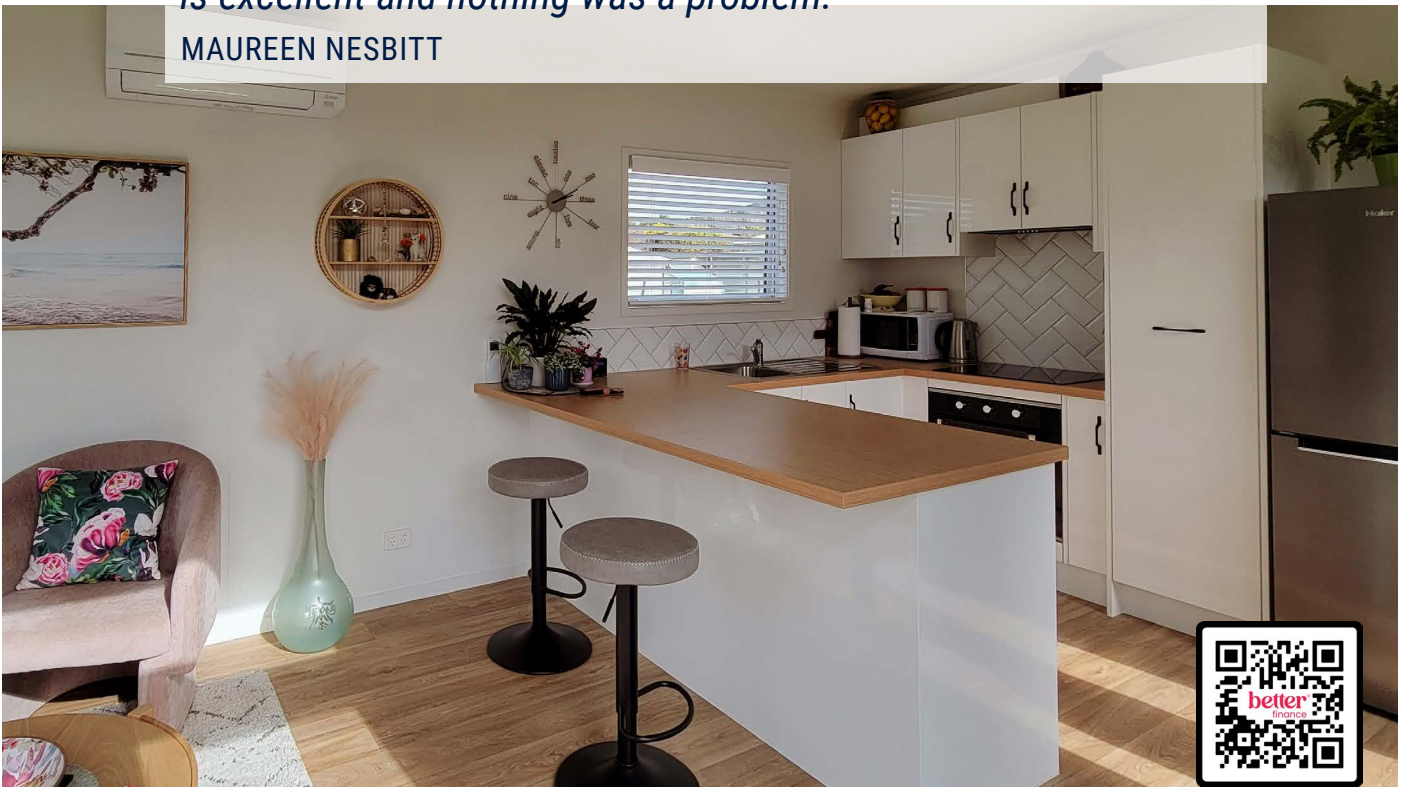

Apply Now

18/09/23



Phone 027 TRU HOME - 027 878 4663

[www.truehomecabins.co.nz](http://www.truehomecabins.co.nz)

[facebook.com/TrueHomeCabins](https://facebook.com/TrueHomeCabins)





“ With ever-increasing house prices, Kiwis are finding it harder and harder to get a foot in the door. I wanted to make it easier for people to own their living space.”

Tāne Rogers - Owner and Builder, True Home Cabins

In early 2020, Tāne established True Home Cabins and continues to expand its products and people.

The team has over 50 years combined experience in the building and engineering industries and a range of quality cabins to choose from.



*“The cabin is exactly what we wanted and we can’t fault the build quality or service that we received from Tane and his team. ”*

JOHN MARTELLI



Apply Now

18/09/23



Phone 027 TRU HOME - 027 878 4663

[www.truehomecabins.co.nz](http://www.truehomecabins.co.nz)

[facebook.com/TrueHomeCabins](https://facebook.com/TrueHomeCabins)

# So much to love

As your family grows adjust your living spaces as you require to maintain a comfortable, practical and affordable lifestyle.

**Create space as your needs change**

**Full insulation** in the ceiling, walls & floor ensuring a healthy and economical environment.

**Relax in comfort**

**Full protection**

A **Certificate of Compliance** is supplied for all utilities covering electricity and gas.

**Remove unnecessary costs**

Transportables generally do not require a code of compliance. Resource consent/building consent may be required to use council services.

Our Quality Assurance Program ensures each unit is manufactured to the highest standards.

**Quality you can trust**

**3 year guarantee** on workmanship and **12 months** on all fixtures and fittings.

**Locally backed guarantee**



*"Workmanship was top notch and I highly recommend them to anyone else looking for a small home."* SHELDON HARVEY



SCAN to apply for finance online



SCAN to read our Google Reviews

Apply Now

## Get in touch



Phone 027 TRU HOME - 027 878 4663

[www.truehomecabins.co.nz](http://www.truehomecabins.co.nz)

[facebook.com/TrueHomeCabins](https://facebook.com/TrueHomeCabins)